

### 1、电气性能 Electrical Characteristics

序号 NO.	项目 Item	测试条件 Measuring condition	规格 Specification
1	额定电压 Rated voltage	加在电机两端的电压 Voltage applied to both ends of the terminal	DC3.0V
2	额定转速 Rated speed	在额定电压及负荷下测试 At Rated voltage and rated load	14000-20000rpm
3	额定电流 Rated current	在额定电压及负荷下测试 At Rated voltage and rated load	80 mA MAX
4	堵转电流 Stall current	额定电压下锁定电机下测试 At rated voltage locked	150 mA MAX
5	起动车电压 Starting voltage	在额定负载下 At rated load	DC 2.5V MAX
6	电枢电阻 Terminal resistance	端子阻抗 Measure between terminals	30Ω±15%
7	绝缘电阻 Insulation resistance	100V 直流电压下导线与机壳之间 Test between lead wire and case at DC 100V	10MΩ MIN
8	绝缘电压 Insulation voltage	在导线与马达机身之间提供 DC50V 电压一分钟 DC50V between lead wire and motor case for one minute	No destruction occurs
9	机械噪音 Mechanical noise	额定电压下，背景噪声≤30 dB(A),电机固定在测试夹具上，拾音器沿轴向正对电机平面，距离 10 cm。 At rated voltage, Back ground noise: 30 dB(A) Max, Fix the motor in a test jig. Microphone is faced to the motor and recedes by 10cm	45dB(A)MAX
10	振动量 Vibration swing	 <p>D 尺寸 size : 5mm 工装 frock : 50×40×10.9mm 重量 weight : 60±1g, 材质: 铝 Weight Material: Aluminum</p>	≥0.45G (Peak)

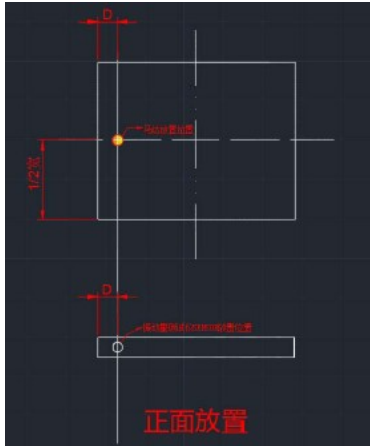

# 技术参数

technical parameter

DM-BL0625-5B

## 2、产品外形图 Product Drawing

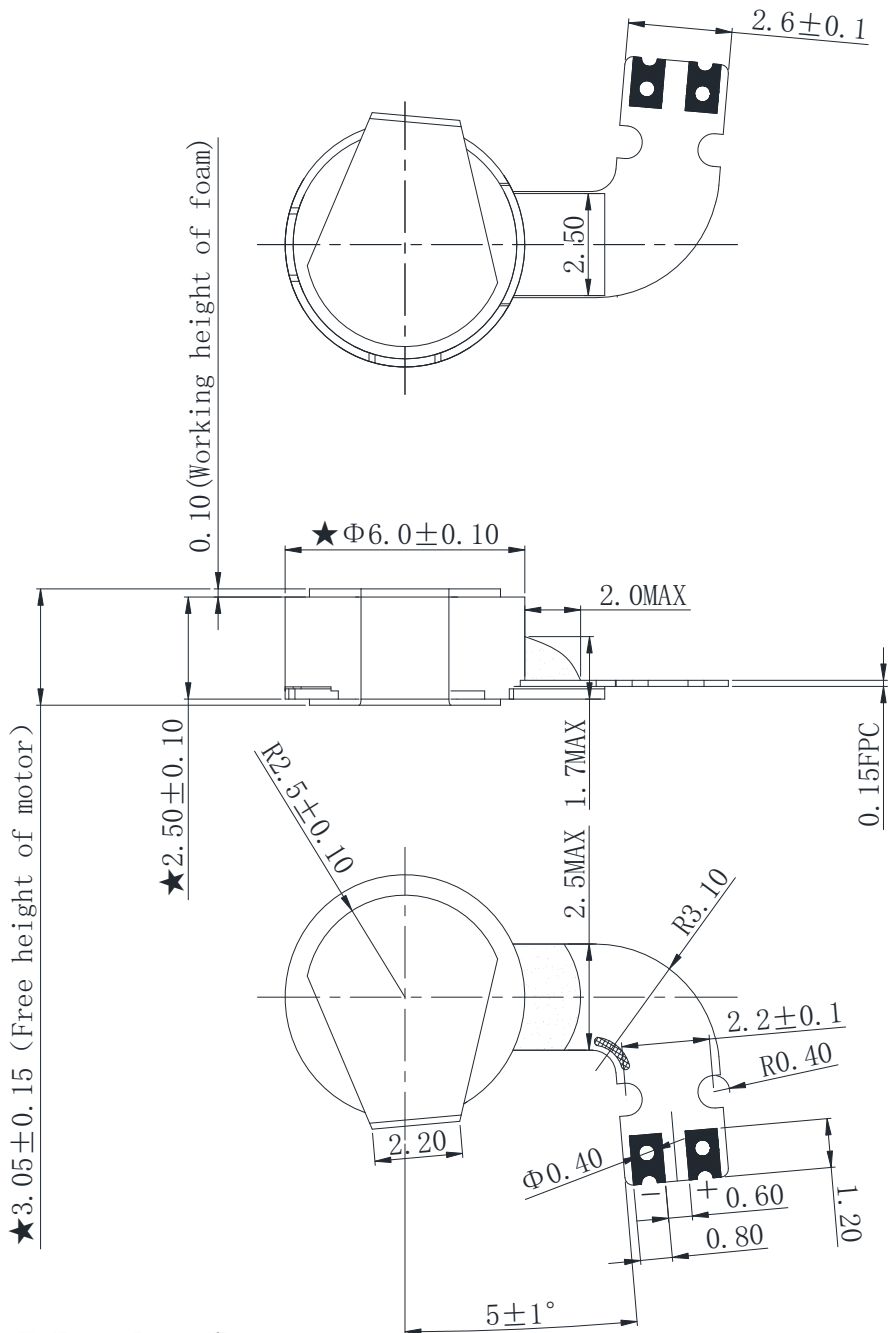

### 技术要求 (Technical requirement):

1. 未注尺寸公差为 $\pm 0.2\text{mm}$ 。(Unnoted dimensional tolerances are  $\pm 0.2\text{mm}$ )
2. 喷码方式如下示例: (Sprurts the code way as follows the example)  
 10月、11月、12月分别用A、B、C表示。(Oct. Nov. and Dec. are represented by ABC)  
 第10日开始用A-Z表示。(Day 10 begins with A~Z)  
 字母O, Q, I, U不做使用 (The letters O, Q, I, and U are not used)

公司代码      D 20 年 (YEAR)  
 (Company code) 8 9 A 1 线别 (The line does not)  
                   | | | |  
                   月 日 班组  
                   Month Day Team