

CORE SETS

Effective core parameters

SYMBOL	PARAMETER	VALUE	UNIT
$\Sigma (1/A)$	core factor (C_1)	1.33	mm^{-1}
V_e	effective volume	4031.50	mm^3
l_e	effective length	73.30	mm
A_e	effective area	55.00	mm^2
A_{\min}	minimum area	55.00	mm^2
W_t	mass of core set	≈ 19.0	g

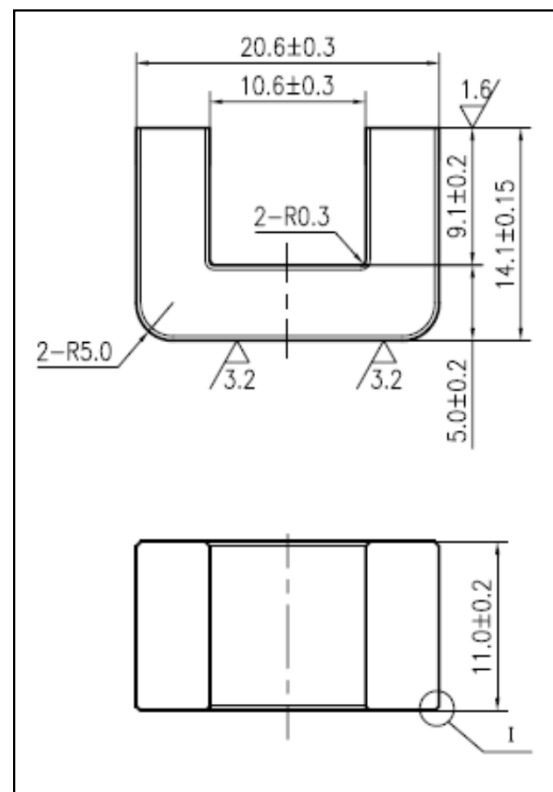

Characteristic

GRADE	AL (nH/N^2)	μ_i
	f=10kHz U=0.25V	f=10kHz U=0.25V
DMR71	$2800 \pm 25\%$	≈ 3800