

CORE SETS

Effective core parameters

SYMBOL	PARAMETER	VALUE	UNIT
$\Sigma (1/A)$	core factor (C_1)	1.56	mm^{-1}
V_e	effective volume	1631.15	mm^3
l_e	effective length	50.50	mm
A_e	effective area	32.30	mm^2
A_{\min}	minimum area	32.25	mm^2
W_t	mass of core set	≈ 8.6	g

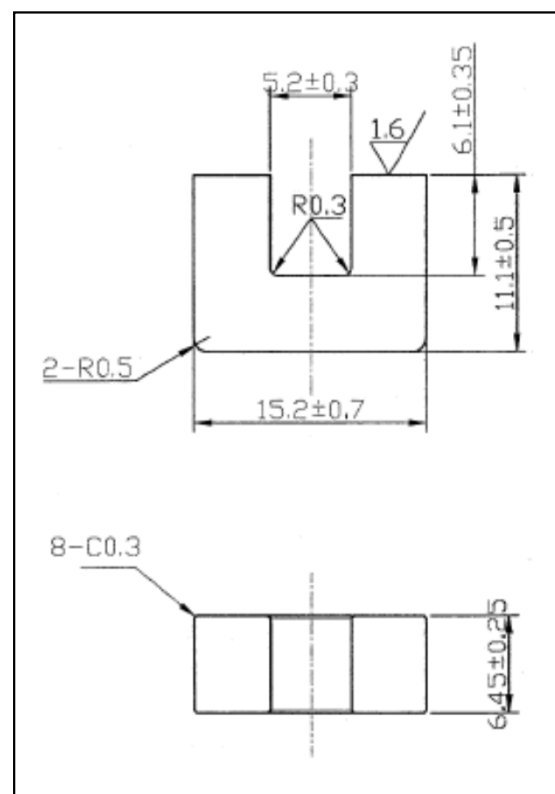

Characteristic

GRADE	AL (nH/N^2)	μ_i
	f=10kHz U=0.25V	f=10kHz U=0.25V
R7K	$3467 \pm 25\%$	≈ 7000