

CORE SETS

Effective core parameters

SYMBOL	PARAMETER	VALUE	UNIT
$\Sigma (1/A)$	core factor (C_1)	1.56	mm^{-1}
Ve	effective volume	1631.15	mm^3
le	effective length	50.50	mm
Ae	effective area	32.30	mm^2
Amin	minimum area	32.25	mm^2
Wt	mass of core set	≈ 8.6	g

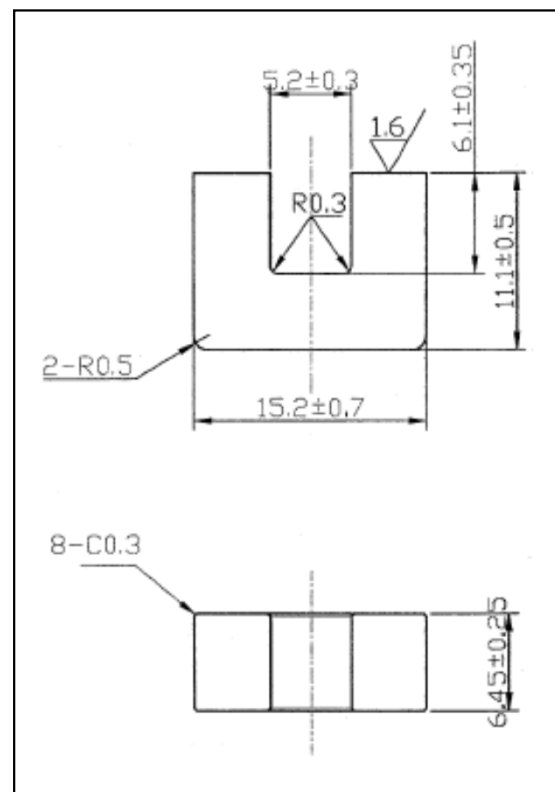

Characteristic

GRADE	AL (nH/N^2)	B (mT)	CORE LOSS (W)
	f=10kHz U=0.25V	H=250A/m f=25kHz T=100°C	f=100kHz B=200mT T=100°C
DMR40	$1500 \pm 25\%$	≥ 250	≤ 1.25
DMR44	$1500 \pm 25\%$	≥ 250	≤ 0.99