

CORE SETS

Effective core parameters

SYMBOL	PARAMETER	VALUE	UNIT
$\Sigma (1/A)$	core factor (C_1)	1.29	mm^{-1}
V_e	effective volume	3888.50	mm^3
l_e	effective length	70.70	mm
A_e	effective area	55.00	mm^2
A_{\min}	minimum area	54.82	mm^2
W_t	mass of core set	≈ 19.8	g

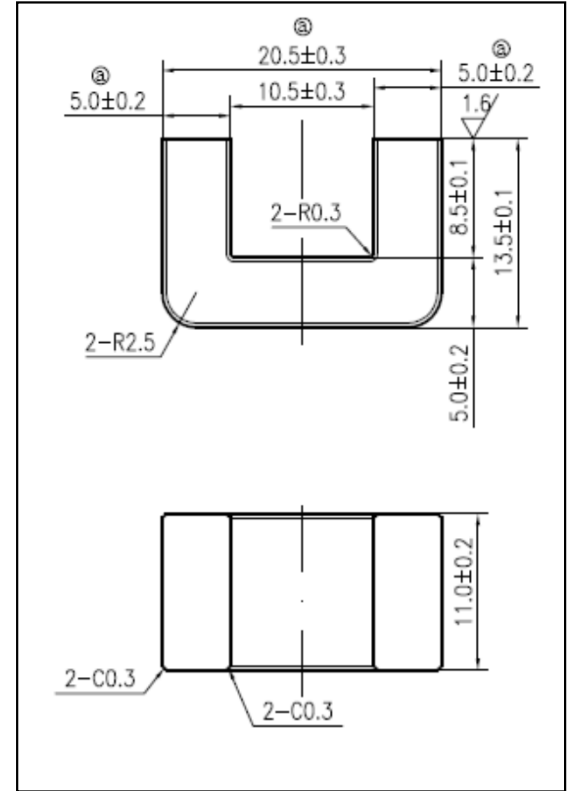

Characteristic

GRADE	$AL (\text{nH}/\text{N}^2)$	μ_i
	$f=10\text{kHz}$ $U=0.25\text{V}$	$f=10\text{kHz}$ $U=0.25\text{V}$
DMR71	$2470 \pm 25\%$	≈ 3800