

CORE SETS

Effective core parameters

SYMBOL	PARAMETER	VALUE	UNIT
$\Sigma (1/A)$	core factor (C_1)	0.40	mm^{-1}
V_e	effective volume	3243.6	mm^3
l_e	effective length	36.0	mm
A_e	effective area	90.1	mm^2
A_{\min}	minimum area	89.9	mm^2
W_t	mass of core set	≈ 17.0	g

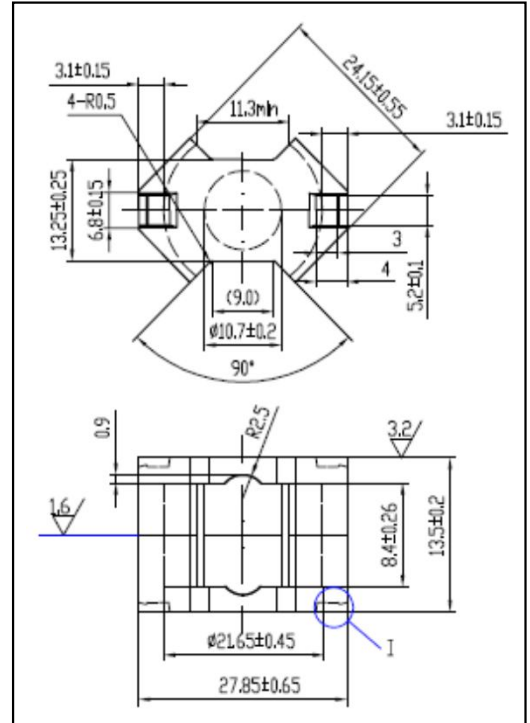

Characteristic

GRADE	AL (nH/N ²)	B (mT)	CORE LOSS (W)
	f=10kHz U=0.25V	H=250A/m f=25kHz T=100°C	f=100kHz B=200mT T=100°C
DMR40	4600 ± 25%	≥ 315	≤ 2.38
DMR44	4600 ± 25%	≥ 315	≤ 2.04
DMR47	4800 ± 25%	≥ 325	≤ 1.79