

CORE SETS

Effective core parameters

SYMBOL	PARAMETER	VALUE	UNIT
$\Sigma (1/A)$	core factor (C_1)	3.36	mm^{-1}
V_e	effective volume	685.44	mm^3
l_e	effective length	48.00	mm
A_e	effective area	14.28	mm^2
A_{\min}	minimum area	13.78	mm^2
W_t	mass of core set	≈ 3.5	g

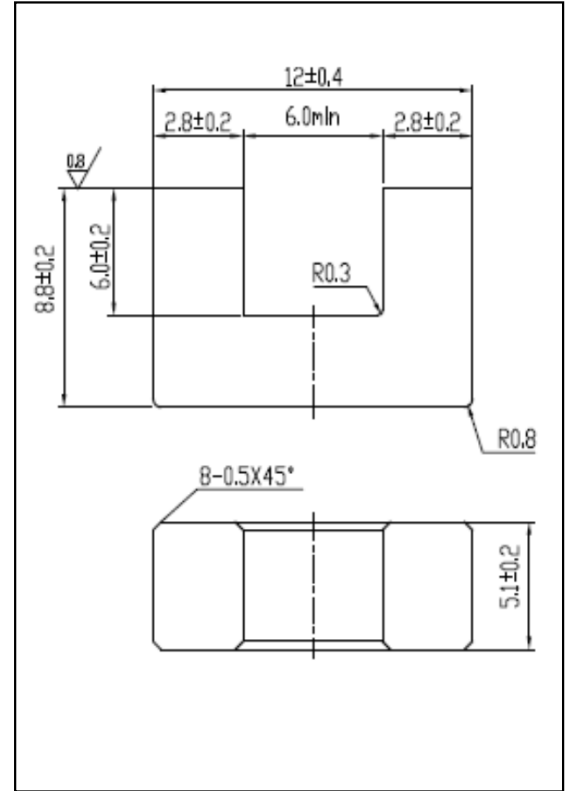

Characteristic

GRADE	$AL (\text{nH}/\text{N}^2)$	μi
	$f=10\text{kHz}$ $U=0.25\text{V}$	$f=10\text{kHz}$ $U=0.25\text{V}$
R5K	$1500 \pm 25\%$	≈ 5000
R7K	$1800 \pm 25\%$	≈ 7000
R10K	$2400 \pm 30\%$	≈ 10000