

## H cores

**DMEGC**  
H101X65X15P

### CORE SETS

#### Effective core parameters

SYMBOL	PARAMETER	VALUE	UNIT
$\Sigma (1/A)$	core factor ( $C_1$ )	0.95	$\text{mm}^{-1}$
$V_e$	effective volume	67032.00	$\text{mm}^3$
$l_e$	effective length	252.00	mm
$A_e$	effective area	266.00	$\text{mm}^2$
$W_t$	mass of core	$\approx 337.9$	g

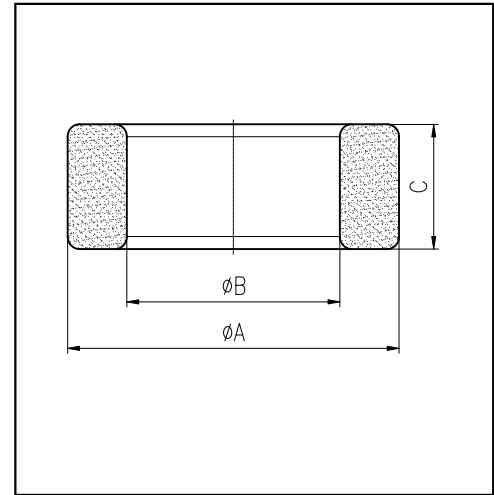

尺寸 Coat	A	B	C
Uncoat	$101.0 \pm 2.0$	$65.0 \pm 1.5$	$15.0 \pm 1.5$
Coated	104.2max	62.5min	17.5max

Note: With grass green epoxy coating

### Characteristic

GRADE	AL ( $\text{nH}/\text{N}^2$ )	B (mT)	CORE LOSS (W)
		f=10kHz U=0.25V	H=250A/m f=25kHz T=100°C
DMR40	$3040 \pm 25\%$	$\geq 320$	$\leq 40.55$