

H cores

DMEGC
H160X133X25P

CORE SETS

Effective core parameters

SYMBOL	PARAMETER	VALUE	UNIT
$\Sigma (1/A)$	core factor (C_1)	1.36	mm^{-1}
Ve	effective volume	153946.73	mm^3
le	effective length	457.63	mm
Ae	effective area	336.40	mm^2
Wt	mass of core	≈ 745.6	g

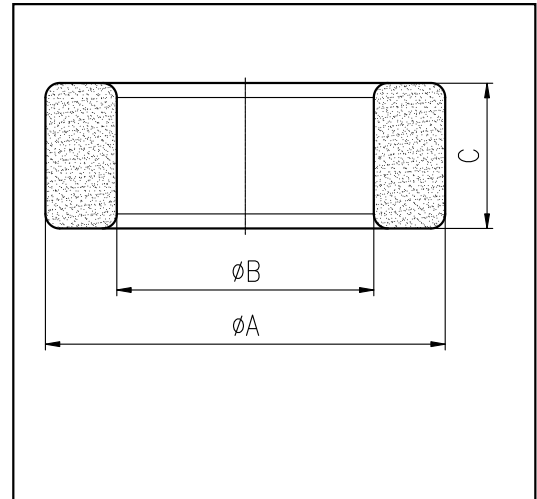

尺寸	A	B	C
Coat			
Uncoat	160.0 ± 3.0	133.0 ± 2.5	25.0 ± 2.5
Coated	164.0_{max}	130.0_{min}	28.0_{max}

Note: With grass green epoxy coating

Characteristic

GRADE	AL (nH/N ²)	B (mT)	CORE LOSS (W)
	f=10kHz U=0.25V	H=250A/m f=25kHz T=100°C	f=100kHz B=200mT T=100°C
DMR40	$2150 \pm 25\%$	≥ 320	≤ 96.9