

### H cores

#### CORE SETS

##### Effective core parameters

SYMBOL	PARAMETER	VALUE	UNIT
$\Sigma (1/A)$	core factor ( $C_1$ )	2.76	$\text{mm}^{-1}$
$V_e$	effective volume	873.98	$\text{mm}^3$
$l_e$	effective length	49.10	mm
$A_e$	effective area	17.80	$\text{mm}^2$
$W_t$	mass of core	$\approx 4.43$	g

尺寸	A	B	C
Coat			
Uncoat	$19.0 \pm 0.3$	$13.0 \pm 0.3$	$6.0 \pm 0.2$
Coated	19.8max	12.3min	6.7max

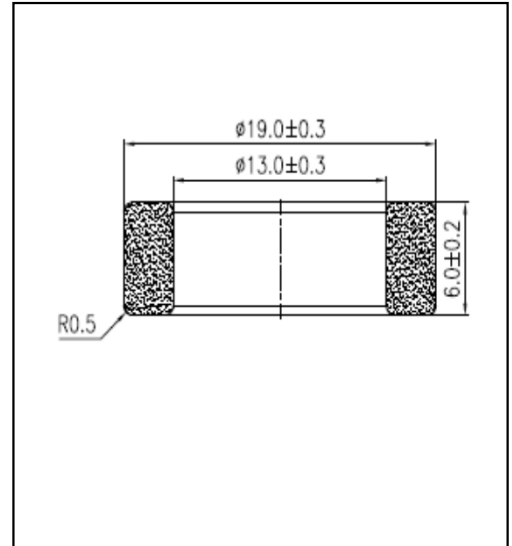

Note: With grass green epoxy coating

#### Characteristic

GRADE	AL ( $\text{nH/N}^2$ )	B (mT)	CORE LOSS (W)
	f=10kHz U=0.25V	H=250A/m f=25kHz T=100°C	f=100kHz B=200mT T=100°C
DMR40	$1046 \pm 25\%$	$\geq 315$	$\leq 0.58$
DMR44	$1046 \pm 25\%$	$\geq 315$	$\leq 0.47$