

H cores

CORE SETS

Effective core parameters

SYMBOL	PARAMETER	VALUE	UNIT
$\Sigma (1/A)$	core factor (C_1)	1.05	mm^{-1}
V_e	effective volume	14632.00	mm^3
l_e	effective length	124.00	mm
A_e	effective area	118.00	mm^2
W_t	mass of core	≈ 82.0	g

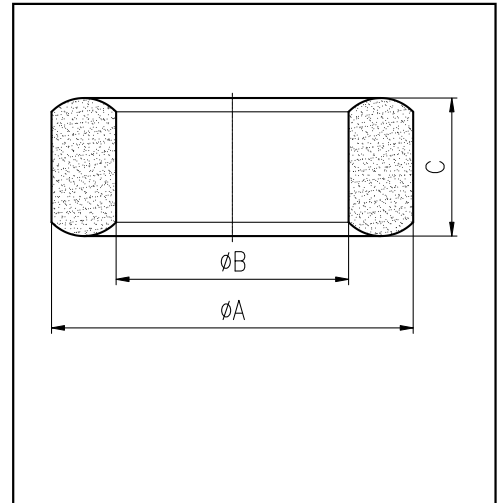

尺寸	A	B	C
Coat			
Uncoat	51.0 ± 0.7	31.0 ± 0.5	13.0 ± 0.4
Coated	52.2max	30.0min	14.0max

Note: With grass green epoxy coating

Characteristic

GRADE	AL (nH/N ²)	B (mT)	CORE LOSS (W)
	$f=10\text{kHz}$ $U=0.25\text{V}$	$H=250\text{A/m}$ $f=25\text{kHz}$ $T=100^\circ\text{C}$	$f=100\text{kHz}$ $B=200\text{mT}$ $T=100^\circ\text{C}$
DMR40	$2900 \pm 25\%$	≥ 315	≤ 10.25
DMR44	$2900 \pm 25\%$	≥ 315	≤ 9.43
DMR95	$4200 \pm 25\%$	≥ 315	≤ 8.61