

H cores

CORE SETS

Effective core parameters

SYMBOL	PARAMETER	VALUE	UNIT
$\Sigma (1/A)$	core factor ( $C_1$ )	0.43	$\text{mm}^{-1}$
$V_e$	effective volume	31590.00	$\text{mm}^3$
$l_e$	effective length	117.00	mm
$A_e$	effective area	270.00	$\text{mm}^2$
$W_t$	mass of core	$\approx 189.3$	g

尺寸	A	B	C
Coat			
Uncoat	$56.0 \pm 1.0$	$26.0 \pm 0.6$	$20.0 \pm 0.5$
Coated	57.6max	25.0min	21.0max

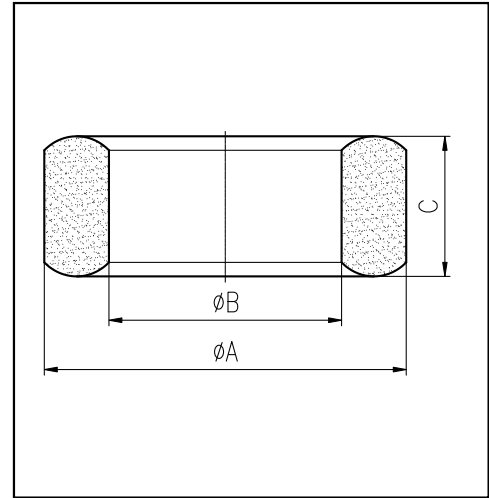

Note: With grass green epoxy coating

Characteristic

GRADE	$AL (\text{nH/N}^2)$	$B (\text{mT})$	CORE LOSS (W)
		$f=10\text{kHz}$ $U=0.25\text{V}$	$H=250\text{A/m}$ $f=25\text{kHz}$ $T=100^\circ\text{C}$
DMR40	$7050 \pm 25\%$	$\geq 315$	$\leq 23.7$
DMR44	$7050 \pm 25\%$	$\geq 315$	$\leq 21.8$
DMR95	$10000 \pm 25\%$	$\geq 315$	$\leq 20.8$