

H cores

CORE SETS

Effective core parameters

SYMBOL	PARAMETER	VALUE	UNIT
$\Sigma (1/A)$	core factor (C_1)	3.23	mm^{-1}
V_e	effective volume	53.06	mm^3
l_e	effective length	13.10	mm
A_e	effective area	4.05	mm^2
W_t	mass of core	≈ 0.31	g

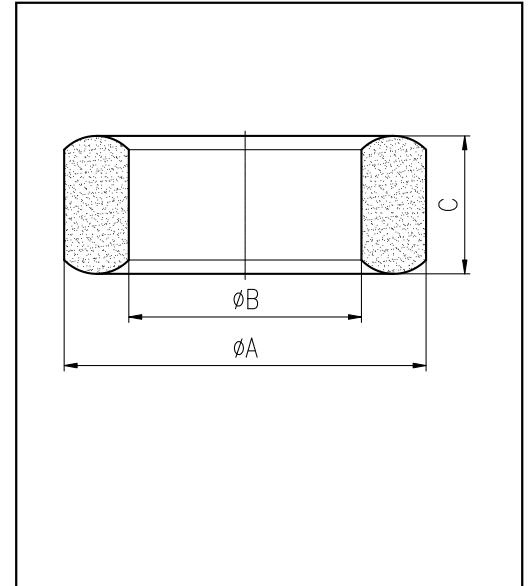

尺寸	A	B	C
Coat			
Uncoat	6.0 ± 0.2	3.0 ± 0.2	3.0 ± 0.3
Coated	6.7max	2.4min	3.6max

Note: With grass green epoxy coating

Characteristic

GRADE	AL (nH/N^2)	B (mT)	CORE LOSS (W)
		$f=10\text{kHz}$ $U=0.25\text{V}$	$H=250\text{A/m}$ $f=25\text{kHz}$ $T=100^\circ\text{C}$
DMR40	$950 \pm 25\%$	—	—
DMR44	$950 \pm 25\%$	—	—